



17/68 Leveson Street North Melbourne VIC

1 1 1

Chic contemporary living has rarely looked better than in this tasteful one bedroom apartment positioned on the ground floor.

View : <https://www.alexkarbon.com.au/lease/vic/inner-city/north-melbourne/residential/apartment/6209134>

The acclaimed Ryan & Leveson building located in a premiere tree lined street is a leisurely 10-minute stroll to the CBD and Queen Victoria Market. Errol Street lifestyle precinct with its many services, cafes and restaurants is only moments away.



Sharon Hibberd
03 9326 8883

An address of this prestige has resulted in a building that is "a cut above the rest" having the hallmarks of serenity and tranquility with a lush central courtyard, the perfect place to lose yourself with a good book. The roof top garden affords stunning views to the CBD and features BBQ's and a practical herb garden.

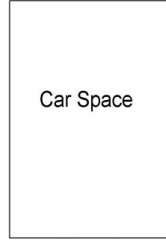
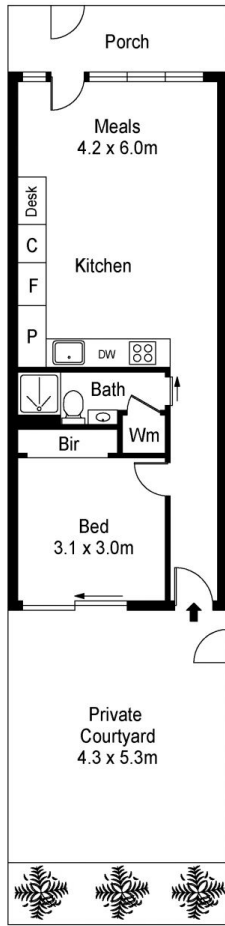

Not In Actual Position



Scale in metres. Indicative only. Dimensions are approximate. All information contained herein is gathered from sources we believe to be reliable. However we cannot guarantee its accuracy and interested persons should rely on their own enquiries



17/68 Leveson Street, North Melbourne