



6/38 Lawson Street Essendon VIC

3 3 1

Conveniently located just moments to Puckle Street eateries, glorious Queens Park, Moonee Ponds Creek Trail, CityLink and an array of public transport options, this townhouse is positioned for livability. Sleek and stylish, the kitchen features a full complement of Blanco stainless steel appliances amid soft-closing cabinetry. Lustrous stone surfaces are also apparent in the European laundry, modern central bathroom and matching powder room. Spacious open plan living extends to a covered balcony enjoying park side vistas. There's also split system air conditioning on both levels, off street parking and video intercom.

View : <https://www.alexkarbon.com.au/lease/vic/north/essendon/residential/townhouse/6209050>



Tasma Bogdanovic
03 9326 8883

Freshly Painted
New Carpet
New Blockout blinds

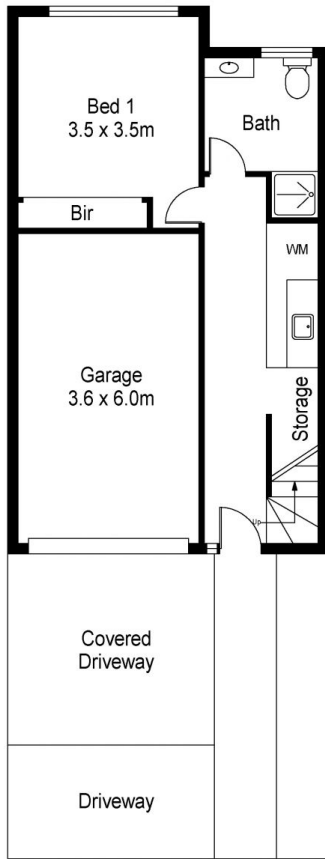

Ground Floor

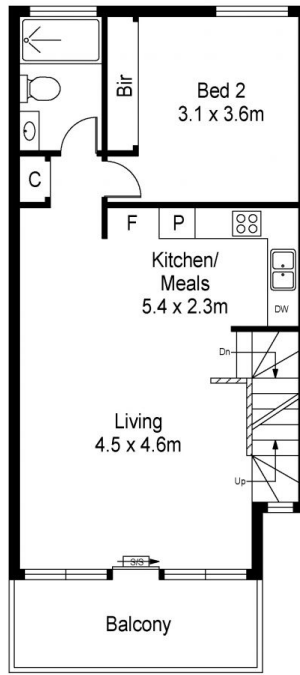

First Floor

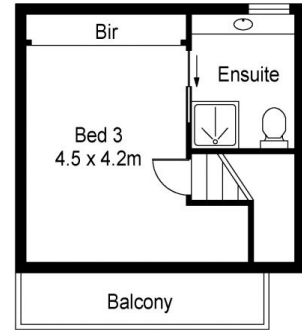

Second Floor



Scale in metres. Indicative only. Dimensions are approximate. All information contained herein is gathered from sources we believe to be reliable. However we cannot guarantee its accuracy and interested persons should rely on their own enquiries



6/38 Lawson Street, Essendon