



**141 Normanby Avenue THORBURY VIC**

4 🏠 1 🚗 1 🚗

Complete with council approvals for an exciting, architect designed, triple townhouse development in a prime locale, this once majestic Four bedroom Californian Bungalow is ready for a new beginning.

A brilliant corner allotment of approximately 573 square metres presents three coveted frontages, they all enjoy a picturesque outlook over Mayers Park. (Plans available for perusal).

Alternatively, a classic facade and high ceilings combined with a generous and functional floor plan, may entice renovation, seeking to restore this original beauty to a showpiece once more.

Conveniently located just 7km from the CBD with St George's Road tram, Northcote Golf Course, Thornbury train station, schools, Merri Creek trails and High Street cafes and shops within easy reach, the residence is also

**Land Size** : 573 sqm  
**View** : <https://www.alexkarbon.com.au/sale/vic/north/thornbury/residential/house/6208504>



**Alex Puglia**  
**03 9326 8883**

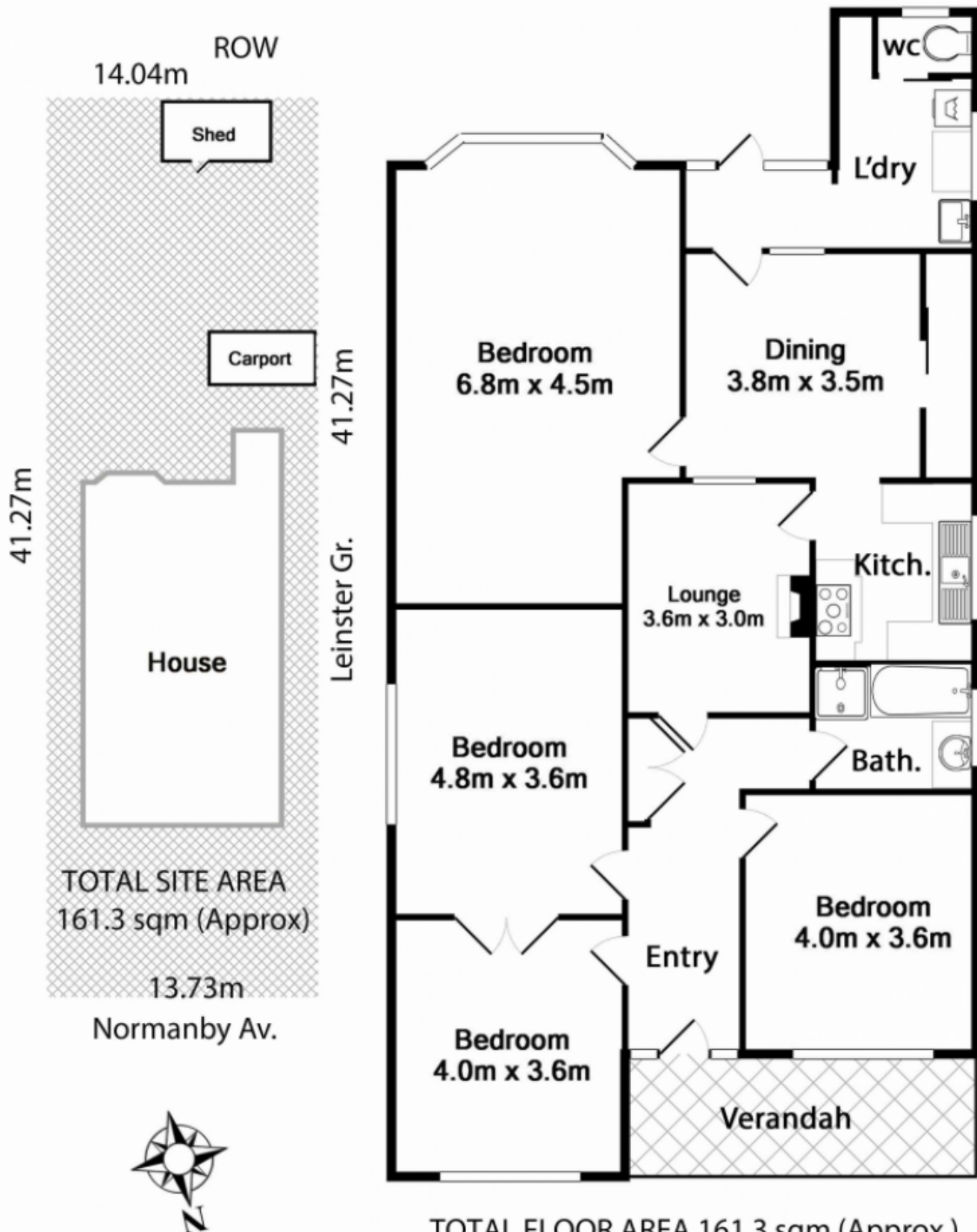

Whilst every attempt has been made to ensure the accuracy of the floor plan contained here, measurements of doors, windows, rooms and any other items are approximate and no responsibility is taken for any error, omission, or mis-statement. This plan is for illustrative purposes only and should be used as such by any prospective purchaser. The services, systems and appliances shown have not been tested and no guarantee as to their operability or efficiency can be given.