

Level 2/608 St Kilda Road MELBOURNE VIC

- Located on Melbourne's gateway Boulevard to CBD.
- Whole Floor Office of 282sqm approx.
- Fully fitted including offices, open space, boardroom and meeting rooms
- Well located in close proximity to CBD, Albert Park, Botanical Gardens, Melbourne Sports Aquatic Centre, Toorak Road & Chapel Street
- Located on the fringe of CBD, public transport at the door stop, great access to Nepean Highway & Dandenong Road.
- Three (3) on title car parks, with the capability to accommodate 4.
- Great opportunity for owner occupier, investor or self-managed super fund (SMSF).

Building Size : 282 sqm
View : <https://www.alexkarbon.com.au/sale/vic/inner-city/melbourne/commercial/retail/6208067>



Charles Bongiovanni
03 9326 8883

LEVEL 2, WEST TOWER, 608 ST KILDA ROAD, MELBOURNE

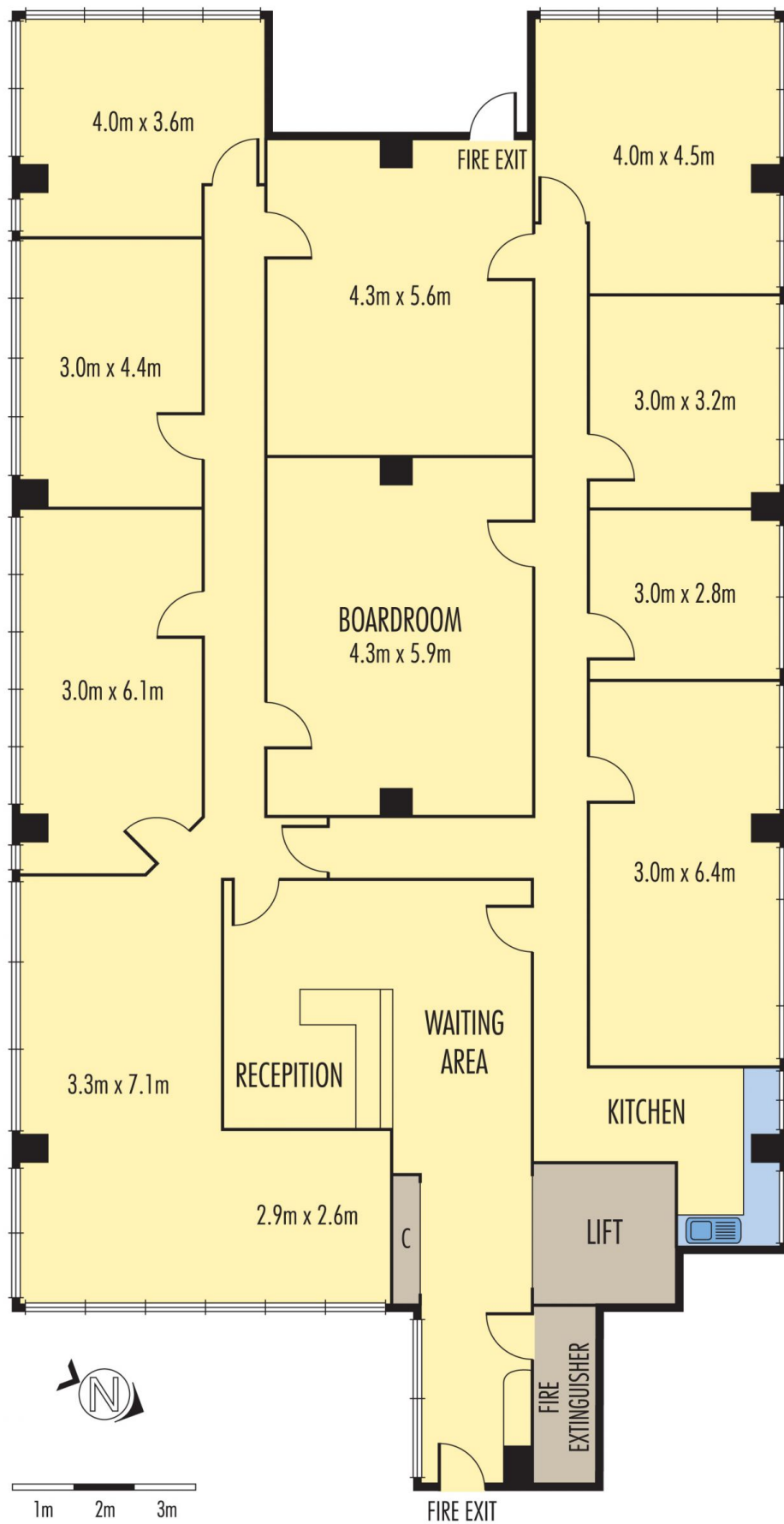

Disclaimer: Please note plans are indicative only and not drawn to exact scale. All dimensions are approximate. Potential buyers should view the property in person.